

Memorandum

To: Williams Tower Tenants

From: Property Management

Date: **March 25, 2010**

RE: AVAILABLE CONFERENCE CENTERS ON LEVEL 62

Hines

Williams Tower has four conference rooms available for tenant use. You may wish to keep the conference center in mind as a backup to your regular facilities when you have the need for an additional or larger meeting area.

Beacon Room: Seats up to 75 people (auditorium seating only). Flexible setup options with round or rectangular tables. Includes a projector, glass dry-erase boards, and speakers.
Pricing: \$200.00 (4-8 hrs.) \$100.00 (less than 4 hrs.)
(Beacon Room is referenced as Conference Room B on property website)

Tower Room: Seats approximately 20-25 people, features great views of downtown. Setup options allow for your choice of conference table or classroom style seating. Includes a projector with speakers and a glass dry-erase board.
Pricing: \$100.00 (4-8 hrs.) \$75.00 (less than 4 hrs.)
(Tower Room is referenced as Conference Room C on property website)

WaterWall Room: Seats 12 people. Includes Polycom, flat screen TV, and DVD player with large conference table. Laptop may be connected to screen, but should be verified prior to ensure it is feasible for your meeting.
Pricing: \$50.00 (4-8 hrs.) \$25.00 (less than 4 hrs.)
(WaterWall Room is referenced as Conference Room A on property website)

Post Oak Room: Seats 8 people, features great views of Galleria-area. Includes a conference table, dry-erase board, and projector. This room comes with use of a neighboring guest office with a computer and printer.
Pricing: \$50.00 (4-8 hrs.) \$25.00 (less than 4 hrs.)
(Post Oak Room is referenced as Conference Room D on property website)

Attached are diagrams and amenities concerning use of these areas. To check availability or make a reservation, please visit Resource Scheduling, located under the "Tenant Services" tab on our website, www.williamstower.com, or contact the management office at 713-850-8841

↑
TO
ELEVATOR
LOBBY
AND
RESTROOMS

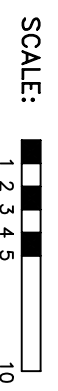
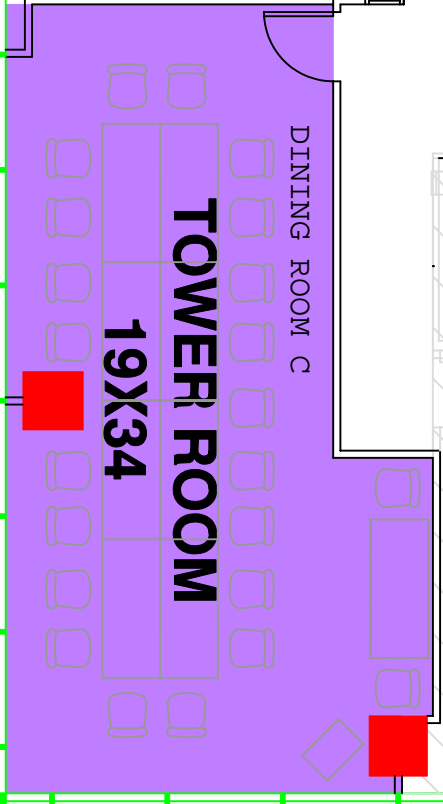
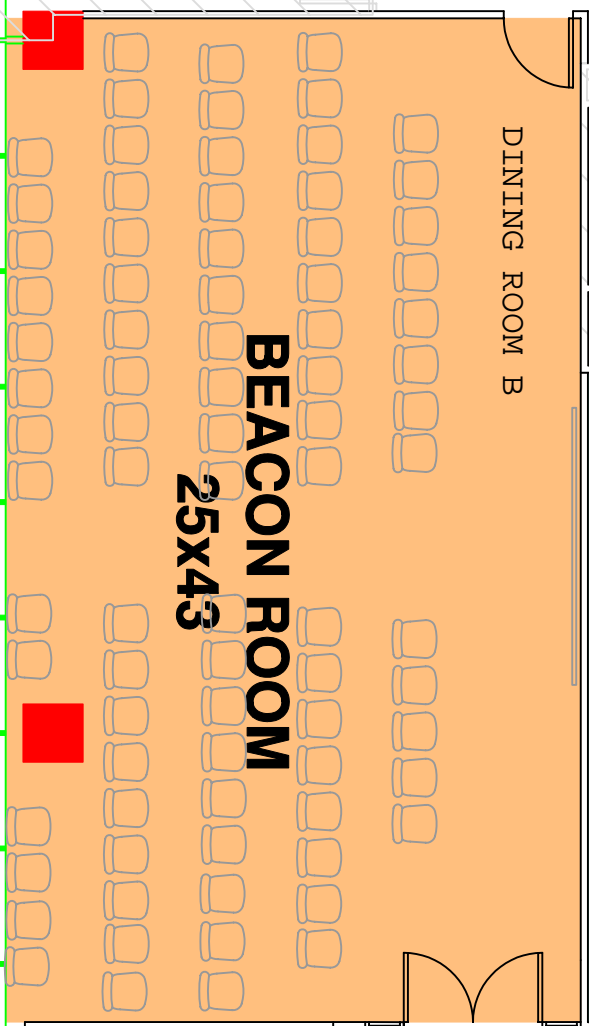
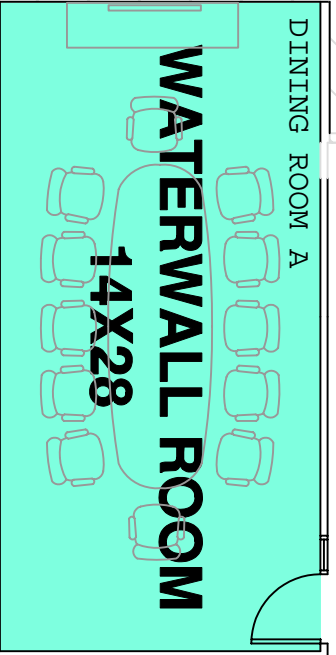

CONFERENCE FACILITY – OVERALL LAYOUT

W I L L I A M S T O W E R – L E V E L 6 2



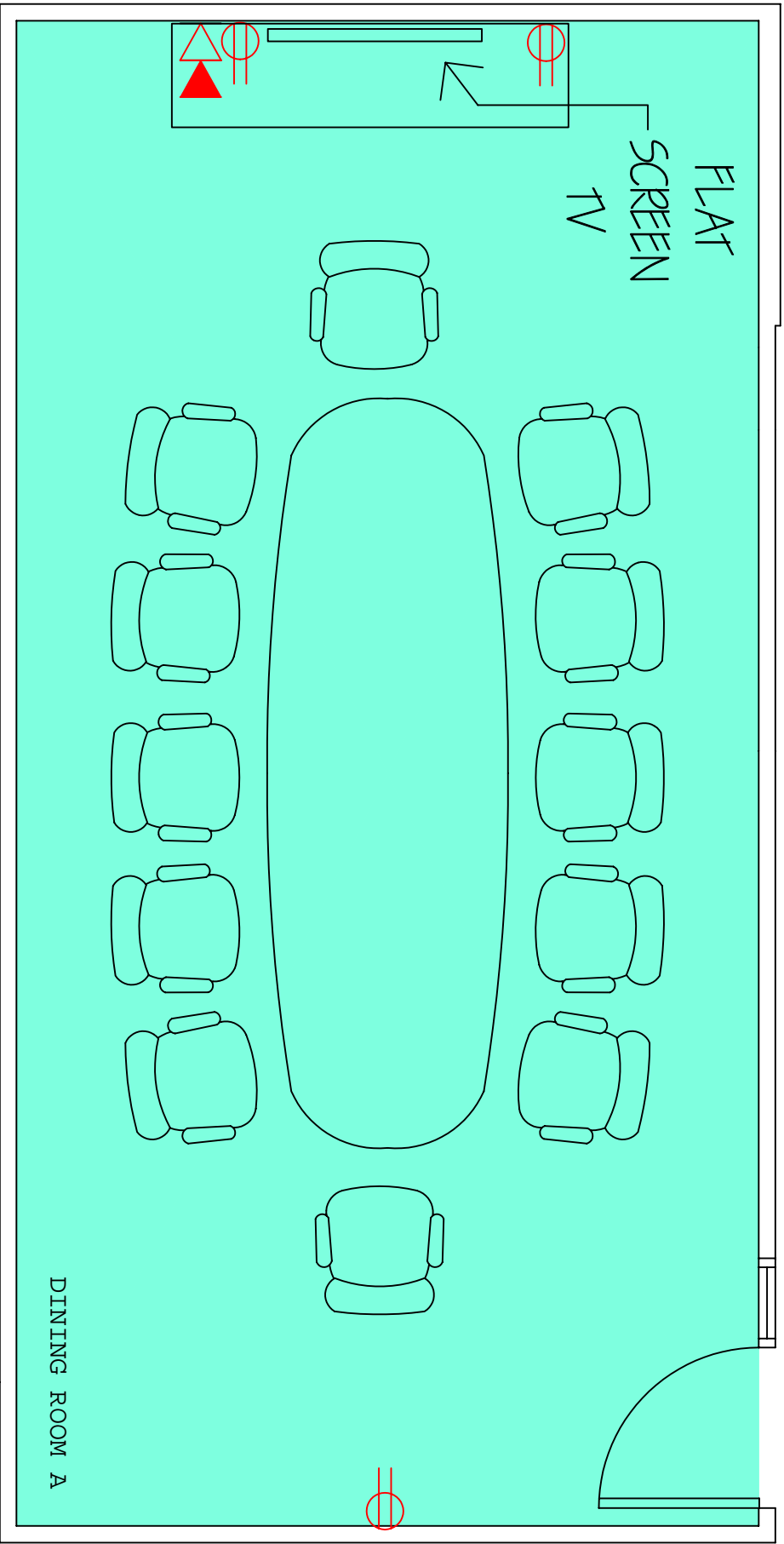

ELECTRICAL LEGEND

- ▶ DATA/COMMUNICATIONS OUTLETS
- ⊗ ELECTRICAL OUTLETS
- FLOOR OUTLETS

SCALE:

1 2 3 4 5 10

NORTH

WATERWALL ROOM—CONFERENCE TABLE (SEATS 12)

W I L L I A M S T O W E R C O N F E R E N C E F A C I L I T Y - L E V E L 6 2

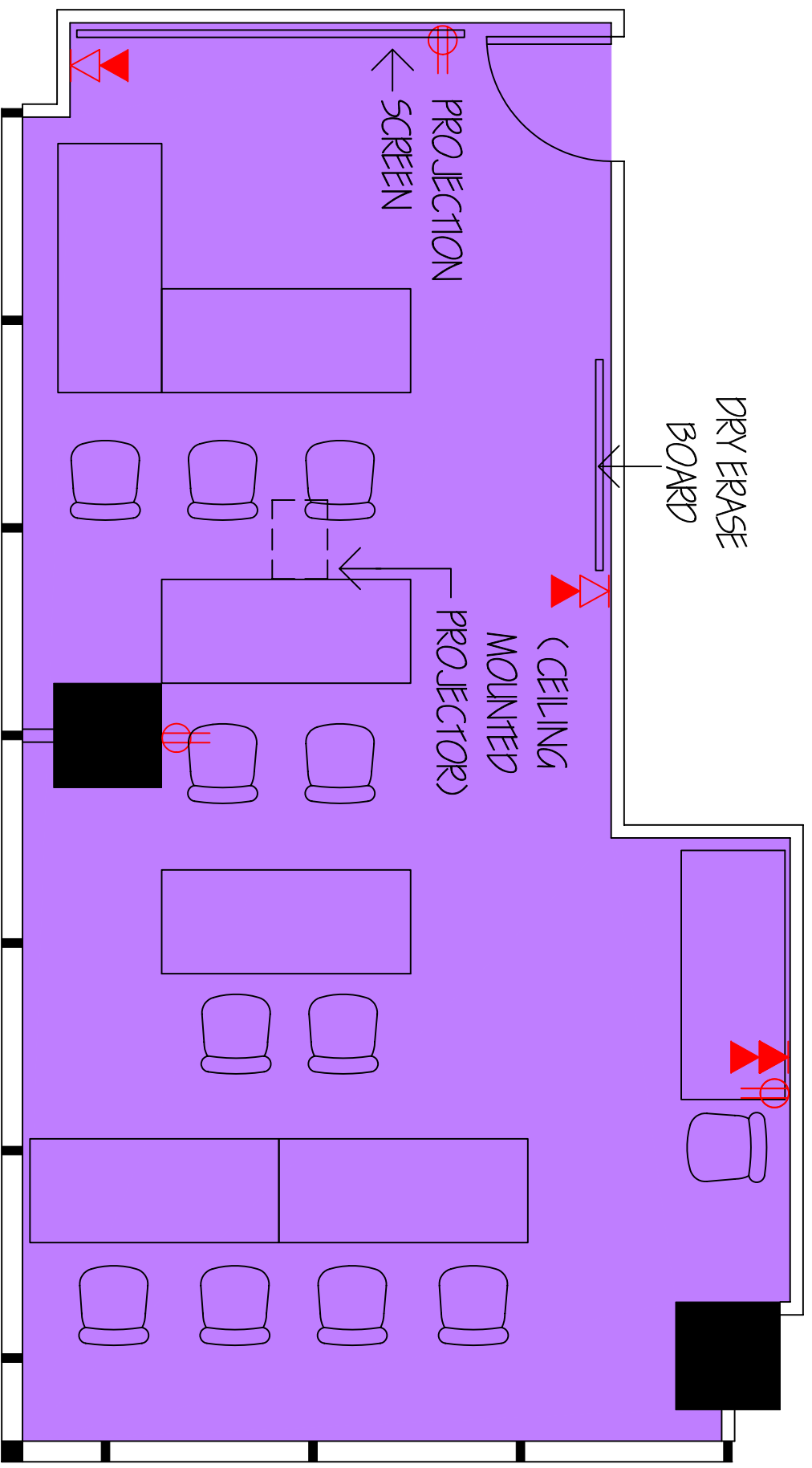

ELECTRICAL LEGEND

- ▶ DATA/COMMUNICATIONS OUTLETS
- ELECTRICAL OUTLETS
- ⦿ FLOOR OUTLETS



TOWER ROOM - CLASSROOM LAYOUT (11 SEATS)

W I L L I A M S T O W E R C O N F E R E N C E F A C I L I T Y - L E V E L 6 2

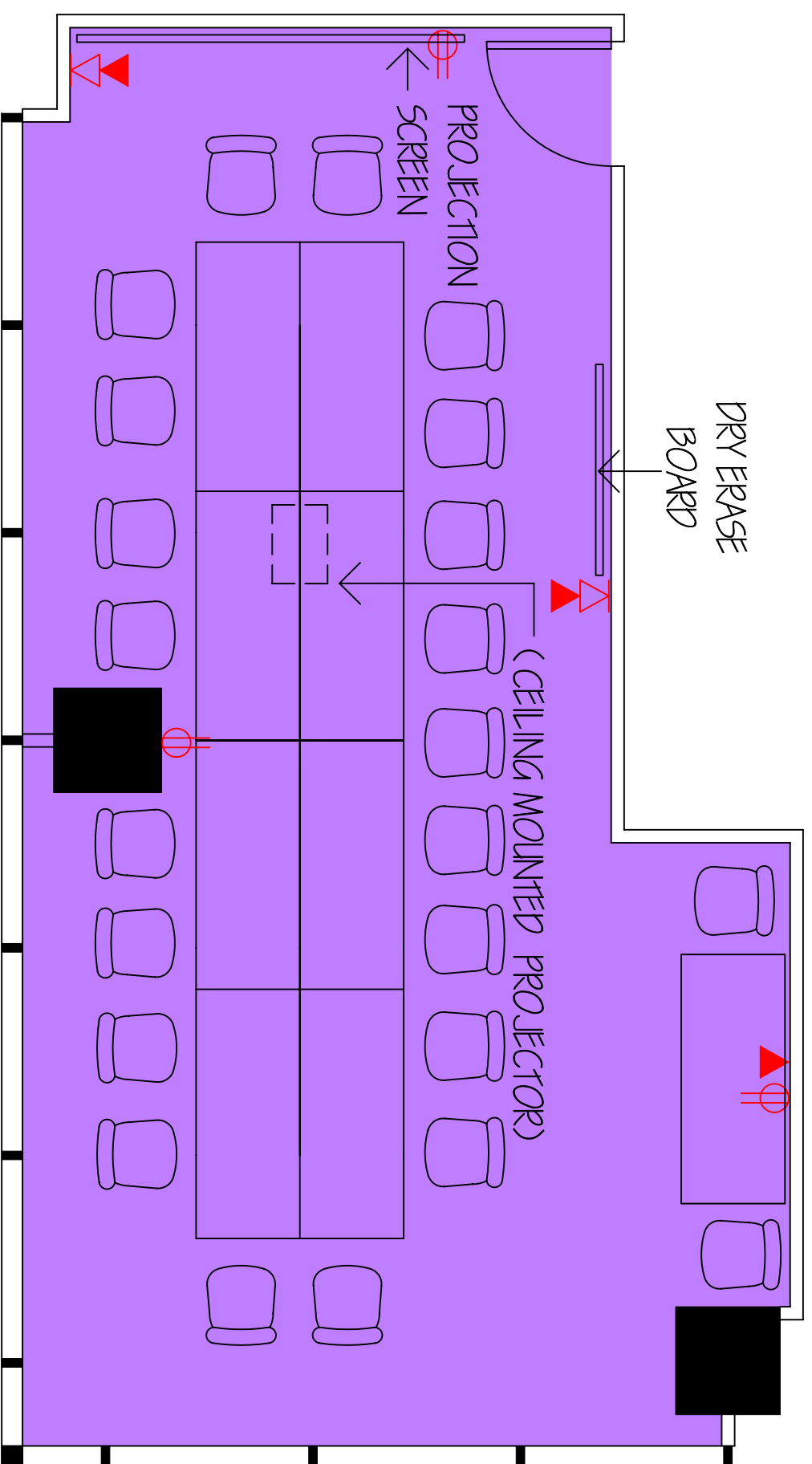

ELECTRICAL LEGEND

- DATA/COMMUNICATIONS OUTLETS
- ELECTRICAL OUTLETS
- FLOOR OUTLETS



TOWER ROOM-BANQUET LAYOUT (21 SEATS)

W I L L I A M S T O W E R C O N F E R E N C E F A C I L I T Y - L E V E L 6 2

W I L L I A M S T O W E R C O N F E R E N C E F A C I L I T Y - L E V E L 6 2

BEACON ROOM-AUDITORIUM SEATING (75 SEATS)

ELECTRICAL LEGEND

- DATA/COMMUNICATIONS OUTLETS
- ELECTRICAL OUTLETS
- FLOOR OUTLETS

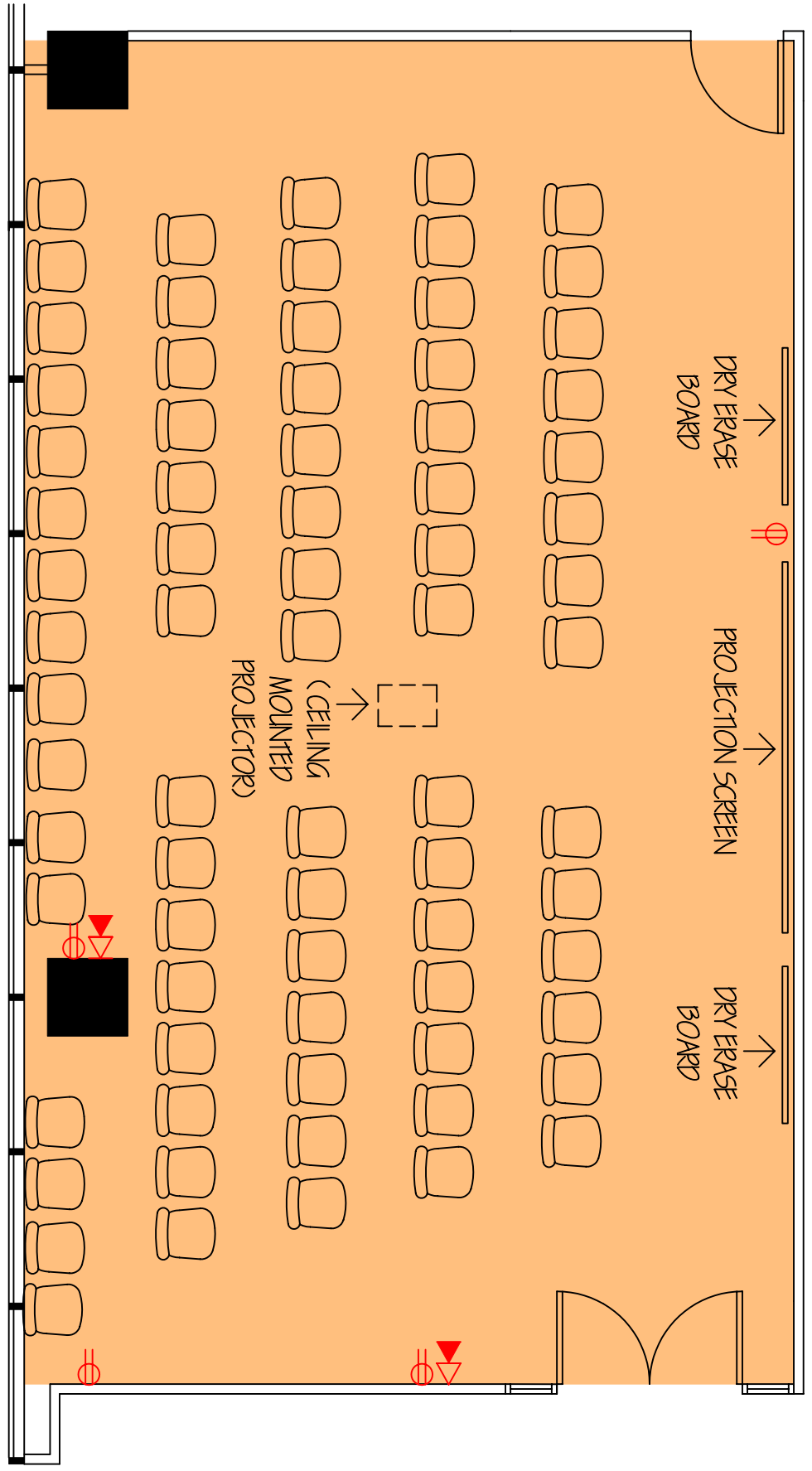

SCALE: 1 2 3 4 5 10



NORTH